

The following features are available in this PDF document.



Quick Keyword Search

Enter the keyword in the search box and hit the search button



Quick Jump between Chapters

Click the title of a specific chapter on the Contents to jump to it

*Reading software such as Adobe Reader is needed to support the functions above.



ZHIYUN CINEPEER CF100

User Guide

Contents

□ Brief Introduction	
Brief Introduction	1
□ Product List	
Product List	3
□ Get to Know ZHIYUN CINEPEER CF100	
Get to Know ZHIYUN CINEPEER CF100	4
□ Charging	
Charging	5
□ Installing Modifiers	
Installing and Removing Barndoors	7
Installing and Removing Diffuser	9
Installing Tripod	11
Installing the Light Stand	12
□ How to Use ZHIYUN CINEPEER CF100	
Buttons and Dials	13
Operation Instruction	14
□ Firmware Upgrade	
□ Product Specifications	
□ Disclaimer and Warnings	
Reading Tips	20
Safe Operation Instructions	21

☐ Warranty Card

Warranty Period 22

Warranty Exclusions 22

Warranty Claim Procedure 22







☐ Contact Card

Brief Introduction

The ZHIYUN CINEPEER CF100 stick light is a high-power, portable handheld LED fill light with a compact size but powerful performance. It supports RGB color adjustment function, comes with various lighting effects, and is capable of meeting the fill light requirement of various application scenarios such as video recording, live interviews, still life photography, etc. The product has the following highlights:

1. Slender and portable, easy to use.
2. Capable of adjusting brightness/color temperature/hue/saturation freely.
Applicable to a wide range of scenarios.
3. Features high-intensity lighting for your night-shoot.
4. Features great color rendering performance to show object colors more naturally.
5. Visible parameters on the screen, convenient for setting.
6. Built-in fans for an effective cooling effect.
7. Various lighting effects are available for more creative lighting.
8. Supports PD fast charging and can be operated while charging.

WARNING

-  This product is not waterproof. Prevent contact with any kind of liquid with the ZHIYUN CINEPEER CF100. Never use the product in the rain or a humid environment.
-  If water accidentally enters the device when using, please stop using it immediately and contact the company or authorized maintenance personnel for maintenance, and continue to use it only when the maintenance is finished.
-  Do not expose this product to corrosive chemicals, inflammable and explosive materials.
-  Do not touch the heating part when the product is working to avoid getting burned.
-  Do not wrap or block the fans to avoid cooling effect damage.
-  Do not turn the product directly to the eyes to avoid eyesight damage.
-  Do not expose this product to an environment above 40°C .

Battery safety precautions:

- ① It is strictly prohibited to use batteries that are not provided by ZHIYUN.
If you need to replace the battery, please contact ZHIYUN or designated agents. ZHIYUN will not be responsible for any battery accidents or equipment malfunctions caused by using batteries that are not officially provided by ZHIYUN.
- ② If the battery bulges, leaks, or has other abnormalities, please stop using it immediately and contact ZHIYUN customer service or designated agents for further processing.
- ③ Do not completely discharge the battery and store it for a long time to prevent the battery from entering an over-discharged state and causing damage to the battery cell, which may make it impossible to recover and reuse.

BE CAREFUL

1. This product is a high-precision control device. Damage may be caused to the product if dropped or subject to external force, and this may result in malfunction.
2. Please keep your hands dry while using the product and use a soft dry cloth for cleaning.
3. Keep this product out of the reach of children.
4. When not using this product, please disconnect the external power supply.
5. Do not place any other items on top of this product to avoid damage to this product.
6. Protect the product from dust and sand during use.
7. Before storing this product, please make sure it is completely cooled and store it in a dry and ventilated place.
8. Do not disassemble this product on your own. In the event of malfunctions, it should be repaired by ZHIYUN or authorized maintenance personnel.

Product List

Before using this product, please check carefully that all the following items are included in the product package. In case that any item is found missing, please contact ZHIYUN or your local selling agent.



CF100 Light x1



USB Type C Cable x1



Barndoors x1*

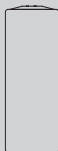

Diffuser x1*



Storage Bag x1*



Quick Start Guide x1

Items marked “*” are included in ZHIYUN CINEPEER CF100 COMBO.

Get to Know ZHIYUN CINEPEER CF100

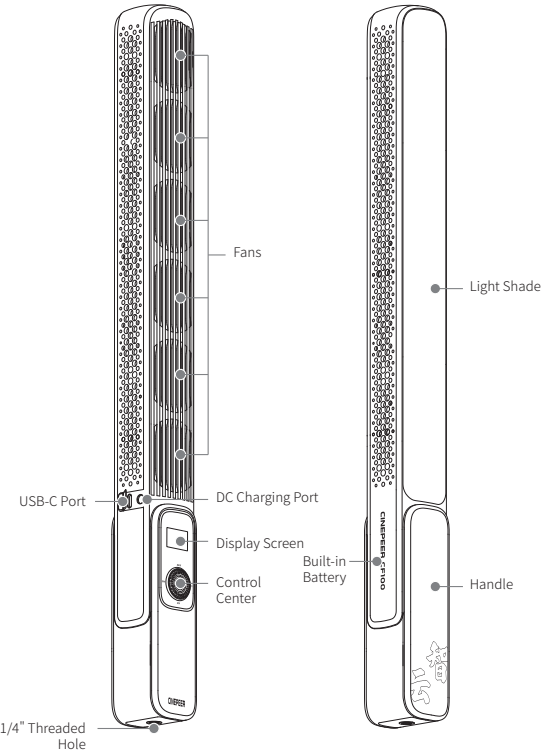

Charging

CINEPEER CF100 adopts high-capacity built-in lithium batteries, providing a solidly long runtime. The battery level is displayed on the screen. The following methods show how to charge your CINEPEER CF100 (you can still use the stick light when charging):

- ① **Charging via USB adapter:** Use the provided USB Type-C charging cable to connect the USB adapter to the stick light's USB-C charging port. Plug the USB adapter into an AC power outlet to charge the stick light.

It is recommended to use a USB adapter that supports the PD fast charging protocol and has a power output of at least 100W. When using the stick light while charging, the USB adapter will prioritize powering the stick light, and the remaining power will charge the battery. The maximum charging power for the battery is 25W.

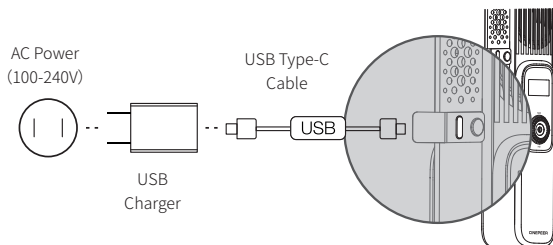

- 💡 USB adapter and PD fast charging cable with 100W or above are not provided and should be prepared on your own.

- ② **Charging via DC power adapter:** Connect the DC power adapter to the stick light's DC charging port and an AC power outlet to charge the stick light.

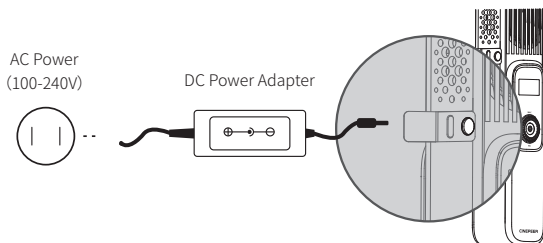

- 💡 ① It is recommended to fully charge CF100 before using it. Low battery might impair the product performance.
- ② DC power adapter is not provided and should be prepared on your own. It is recommended to use the 24V/5A power adapter.

Installing and Removing Barndoors

Installing

Expand the barndoors to both sides ① . Put the stick light (light shade side up) into the barndoors groove. Make sure the top of the stick light is aligned with the top of the groove. Press to ensure the stick light is engaged in the barndoors groove ② . Adjust the position of the barndoors according to actual use ③ .

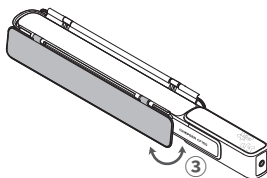
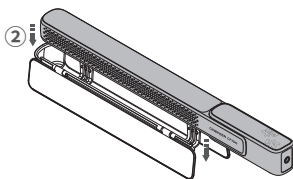
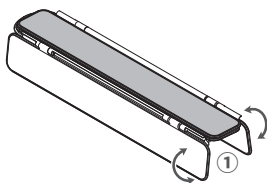

Removing

Expand the barndoors to the position shown in the figure ① . Separate the upper part of the stick light from the groove with your thumbs as shown in the figure ② , while using other fingers to slide the stick light towards the outer side of the groove ③ . Use the same way to slide the lower part of the stick light out of the groove ④ to remove the barndoors.

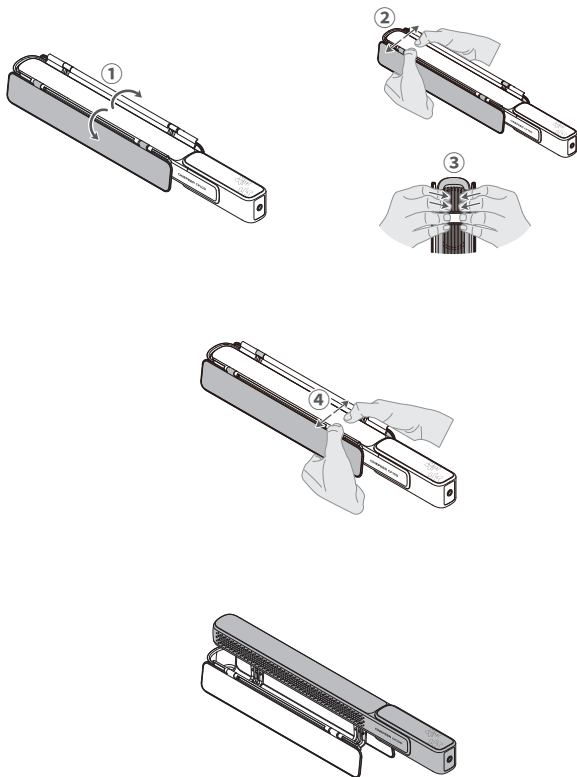

Installing and Removing Diffuser

Installing

Install the barndoors to the stick light and expand the barndoors to both sides to their vertical state ① . Put the diffuser onto the connection of the barndoors and the groove ② . Push the barndoors outward to put up the diffuser ③ .

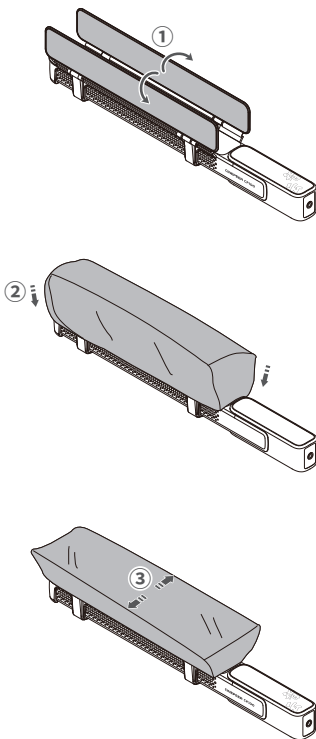

Removing

Push the barndoors inward until the spacing of two becomes smaller

① and remove the diffuser from the ②.

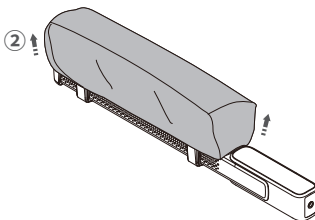
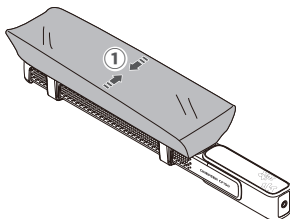

Installing Tripod

Align the 1/4-inch screw at the top of the tripod with the 1/4-inch screw hole at the bottom of the CINEPEER CF100. Then, mount the CINEPEER CF100 onto the tripod.

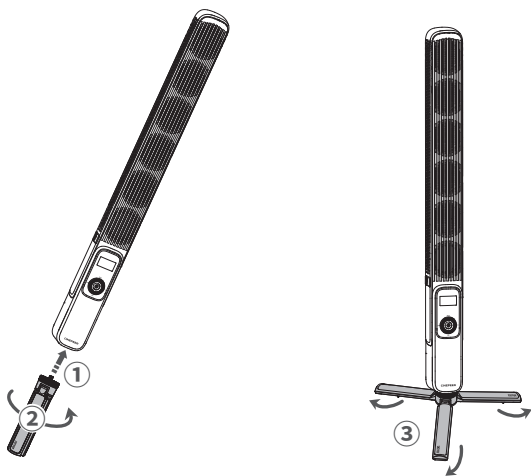

💡 Tripod is not provided. Please prepare separately.

Installing the Light Stand

Align the 1/4-inch screw hole at the bottom of the CINEPEER CF100 with the 1/4-inch screw at the top of the light stand. Then, mount the CINEPEER CF100 to the light stand.

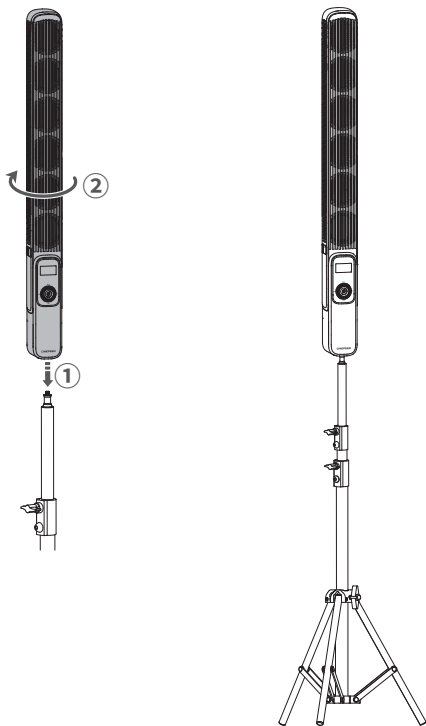

💡 Light stand is not provided in the product package.

⚠ DO NOT stare at the glowing light chips when the device is operating.

⚠ The IP rating of the outer case is IP20.

- 💡 ① When the temperature rises to a certain degree during use, the fan will automatically turn on to achieve the purpose of heat dissipation for the light.
- ② When the temperature is too high, the high-temperature protection mechanism of the stick light will be activated to ensure the safe use of the light.

Buttons and Dials

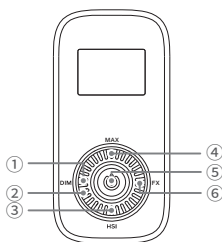

Long press the power button + rotate the dial: Power on

① DIM Button:

Single press: Enter CCT mode.
Switch between brightness/color temperature options (when in CCT mode).

② **Dial:** Adjust parameters.
Switch lighting effect types (when in FX mode).

③ HSI Button:

Single press: Enter HSI mode.
Cycle through Hue/Saturation/Intensity option (when in HSI mode).

④ MAX Button:

Single press to enable/disable MAX mode (when in CCT mode).

⑤ Power Button:

Long press: Power on/off
Double press:
Quickly adjust brightness/color temperature (CCT mode)
Quickly adjust hue/saturation/intensity (HSI mode)
Quickly adjust brightness (FX mode)
Triple press: Lock/unlock the buttons/dials.

⑥ FX Button:

Single press: Enter FX mode.
Switch between lighting effect/brightness option (when in FX mode).

Operation Instruction

1. CCT Mode Settings

Single press DIM button to switch to CCT mode. Press DIM button again to switch to color temperature/brightness option. Double press power button/rotate the dial to adjust the chosen option.

Color temperature adjustment range: 0-100%

Brightness adjustment range: 2700-6500K

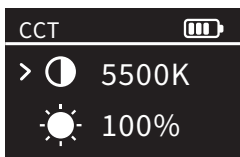

2. MAX Mode Setting

In CCT mode, single press MAX button to enable MAX mode. Press DIM button to switch to color temperature/brightness option. Double press power button/rotate the dial to adjust the chosen option.

Color temperature adjustment range: 0-100%

Brightness adjustment range: 2700-6500K

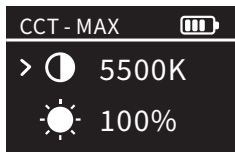

💡 When the MAX mode is enabled, the default brightness is 100% and the default color temperature is 4300K.

3. HSI Mode Settings

Single press HSI button to switch to HSI mode. Press HSI button again to switch to Hue/Saturation/Intensity option. Double press power button/rotate the dial to adjust the chosen option.

Hue adjustment range: 0° -360°;

Saturation adjustment range: 0-100%;

Intensity adjustment range: 0-100%;

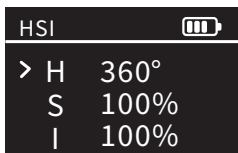

4. FX Mode Settings

Single press FX button to switch to FX mode. Press FX button again to switch to lighting effect/brightness option. Turn the dial to set the lighting effect type. Double press power button/rotate the dial to adjust the brightness.

Lighting effect types: SOS, TV, Faulty Bulb, Candle, Lightning, Flame, Effect0, Effect1, Effect2, Effect3, Effect4, Effect5, Effect6, Effect7

Brightness adjustment range: 0-100%

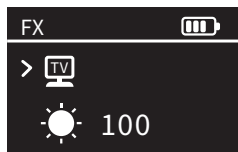

CF100 supports firmware upgrade with “Zhiyun Gimbal Tools”. The following steps show how to upgrade the firmware:

1. Visit the official website of ZHIYUN (www.zhiyun-tech.com), go to the CF100 product page, click “Download”, find the USB driver, the calibration upgrade tool and the firmware and download. (USB drivers are not required for Mac OS systems)
2. Install the driver, unzip the firmware for the documents with the “.ptz” file extension.
3. Turn off CF100.
4. Long press the Max Power button and the Power button at the same time, power on CF100 to enter the upgrade mode.
5. Connect the Type-C port of CF100 to a computer USB port via a Type-C USB cable.
6. Open “Zhiyun Gimbal Tools”, click “Open”, click “Firmware Upgrade”. Click “Browse” under “Path” to select the latest firmware downloaded (with the “.ptz” file extension), and click “Upgrade” at the bottom to upgrade firmware. CF100 will be turned off automatically once the upgrade is successful.

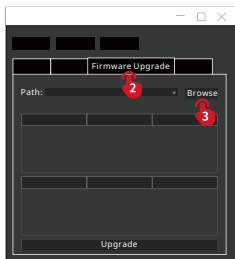
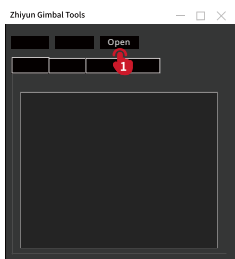
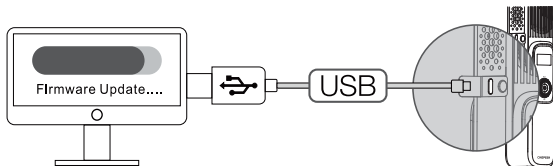

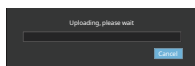
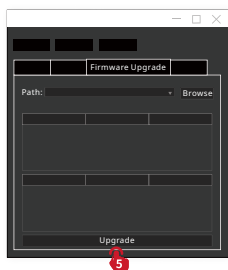
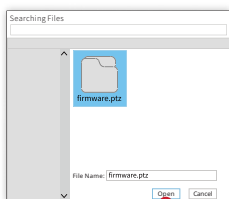

Product Model: PL105

Built-in Battery Capacity	2600mAh/6S	
Max Power	100W	
Color Temperature Range	2700K-6500K	
Dimming Range	0-100%	
CRI/TLCI	CRI \geq 96 TLCI \geq 98	
LED Chip	324pcs	
Charging Time (PD)	2H 56min	Lab Data 1
Charging Time (DC)	3H 3min	Lab Data 2
CCT Mode Illuminance (Max Power)	1370(lux)	Lab Data 3
MAX Mode Illuminance (Max Power)	2610(lux)	Lab Data 4
Runtime (Max Power)	31min	Lab Data 5
Operation Temperature	-10°C -40°C	
Product Size	502*46*47mm	
Product Net Weight	945g	

Lab Data 1: When the temperature is 25°C , the charging time is 2h 56 mins via 25W Power Delivery. The actual charging time varies under different conditions: the lower the charging temperature, the lower the charging current, leading to a longer charging time.

Lab Data 2: When the temperature is 25°C , the charging time is 3h 3 mins via 25W-28W DC charging The actual charging time varies under different conditions:

the lower the charging temperature, the lower the charging current, leading to a longer charging time.

Lab Data 3: With 25°C temperature, indoor illuminance lower than 0.1lux, and 1m test distance, set the product in CCT mode, 6500K color temperature, 100% brightness, and the illuminance is 1370 lux. The actual illuminance varies under different conditions.

Lab Data 4: With 25°C temperature, indoor illuminance lower than 0.1lux, and 1m test distance, set the product at 4300K color temperature, 100% brightness, the light is powered via DC adapter in max power, and the illuminance is 2610 lux. The actual illuminance at the max power varies under different conditions.

Lab Data 5: With 25°C temperature and a full battery level, set the product at 4300k color temperature, 100% brightness, and the max power, and the battery runtime is 31 mins. The actual battery runtime varies under different conditions: the longer the operating time, the higher the charge and discharge frequency, and the less battery activity, leading to a shorter battery runtime.

The above data is gathered from internal experiments of ZHIYUN laboratories. Under different scenarios, data is different to some extent. Please refer to the actual use.

Thank you for purchasing this product. The information contains herein affects your safety, legitimate rights and obligation. Please read this instruction carefully to ensure proper configuration before use. Failure to read and follow this instruction and warnings herein may result in serious injury to you or bystanders, or damage to your device or property. Guilin Zhishen Information Technology Co., Ltd (hereinafter referred to as "ZHIYUN") reserves all rights for final explanation of this instruction and other documents related to this product. The information is subject to update without notice. Please visit www.zhiyun-tech.com to obtain the latest product information.

By using this product, you hereby signify that you have read this document carefully and that you understand and agree to abide by the terms and conditions herein. You agree that you are solely responsible for your own conduct while using this product, and for any consequences thereof. You agree to use this product only for purposes that are proper and in accordance with all terms, precautions, practices, policies and guidelines ZHIYUN has made and may make available.

ZHIYUN accepts no liability for damage, injury or any legal responsibility incurred directly or indirectly from the use of this product. Users shall observe safe and lawful practices including, but not limited to, those set forth herein.

ZHIYUN™ is the trademark of Guilin Zhishen Information Technology Co., Ltd and its affiliates. All product names or trademarks referred to herein are trademarks or registered trademarks of their respective holders.

Reading Tips

Legends:  Hints and Tips

 Important

Safe Operation Instructions

Read the ENTIRE User Guide to become familiar with the features of this product before operating. Failure to operate the product correctly can result in damage to the product or personal property and cause serious injury. This is a sophisticated product. It must be operated with caution and common sense and requires some basic mechanical ability. Failure to operate this product in a safe and responsible manner could result in injury or damage to the product or other property. This product is not intended for use by children without direct adult supervision.

DO NOT use with incompatible components or in any way otherwise as mentioned or instructed in the product documents provided by ZHIYUN. The safety guidelines herein contain instructions for safety, operation and maintenance. It is essential to read and follow all of the instructions and warnings in the User Guide, prior to assembly, setup or use, in order to operate the product correctly and avoid damage or serious injury.

Warranty Period

1. Customers are entitled to replacement or free repair service in case of quality deficits found in the product within 15 days upon receipt of the product.
2. Customers are entitled to free repair service from ZHIYUN for any product proven defective in material or workmanship that results in product failure during normal consumer usage and conditions within the valid warranty period, which is 12 months counting from the date of selling. However, warranty period varies by product component and country of purchase. Please contact our after-sales service team on ZHIYUN official website or your place of purchase for detailed warranty information.

Warranty Exclusions

1. Products subjected to unauthorized repair, misuse, collision, neglect, mishandling, soaking, accident, and unauthorized alteration.
2. Products subjected to improper use or whose labels or security tags have been torn off or altered.
3. Products whose warranty has expired.
4. Products damaged due to force majeure, such as fire, flood, lightning, etc.

Warranty Claim Procedure

1. If failure or any problem occurs to your product after purchase, please contact a local agent for assistance, or you can always contact ZHIYUN's customer service through email at info@zhiyun-tech.com or website at www.zhiyun-tech.com.
2. Your local agent or ZHIYUN's customer service will guide you through the whole service procedure regarding any product issue or problem you have encountered. ZHIYUN reserves the right to reexamine damaged or returned products.

Customer Information

Customer Name:

Phone Number:

Address:

Sales Information

Sales date:

Product Serial Number:

Distributor Name:

Distributor's Contact Number:

First Maintenance Record

Service Date:

Repairman Signature:

Cause of Problem:

Service Result:

☐ Solved☐ Unsolved☐ Refunded/Replaced



Website



Weibo



Vimeo



Google+



Facebook
(Zhiyun Support)



Facebook
(Zhiyun Tech)



Youku



Youtube



Wechat



Instagram

Tel: +86 400 900 6868

USA Hotline: +1 808-319-6137, 9:00-18:00 GMT-7, Mon-Fri

Europe Hotline: +49 (0) 61018132180, 10:00-17:00 GMT+1, Mon-Fri

Web: www.zhiyun-tech.com

E-mail: info@zhiyun-tech.com

Address: 09 Huangtong Road, Tieshan Industrial Zone, Qixing District, Guilin, 541004, Guangxi, China

Certificate of Quality

This product is confirmed to meet quality standards and permitted for sale after strict inspection.

QC Inspector: _____



For full product information, please visit ZHIYUN's official website: Content on www.zhiyun-tech.com is subject to update without notice.

ZHIYUN™ is a trademark of ZHISHEN

All product names or brands referred to hereunder may be trademarks or registered trademarks of their respective holders.

Copyright © 2024 ZHISHEN. All rights reserved.

ZHIYUN-TECH.COM