



- Do not shine the LED directly at people's eyes at short distances. This can cause short-term vision issues. Use at distances of at least 1m from subject – or use a reflector/diffuser to soften the light.
- Do not place the LED close to alcohol or flammable objects.
- Do not place liquids on or near the LED. The product is not water, splash or dust resistant.
- Use a soft cloth and neutral cleaner to clean the LED light. Do not use strong cleaning agents or solvents such as thinners, gasoline or alcohol to clean the LED light.
- Do not store the LED at temperatures of +40C as high temperatures may damage the product components.
- Do not use the LED in outdoors in direct sunlight for an extended period of time to prevent the product from overheating and possible damage.

Features

The Phottix Nuada S3II LED is a powerful light source for still and video photography. It uses the latest in flicker-free LED technology, making it efficient and durable.

The Nuada S3II features:

- Softlight design for 40W of flattering light
- Excellent color - CRI rating of 96+ / TLCI 98+
- 2.4G remote control ECO3 with 3 groups and 40 channels
- Digital Brightness and Temperature Control
- Battery and AC Power Modes
- Compact size – 12mm thick

Parts

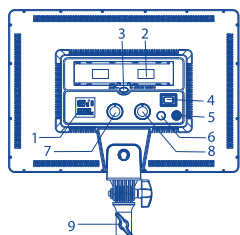

1. LCD Display
2. Battery Mount
3. Battery Release Button
4. Power / Battery / AC modes Switch
5. AC Adapter Port
6. Channel / Group Button (CH/Grp)
7. Brightness Adjustment Dial
8. Color Temperature Adjustment Dial
9. Swivel lock screws

Wireless Remote ECO3

1. LCD
2. Channel / Group button (CH/Grp)
3. ON/OFF button
4. + / - Adjustment Buttons
5. Set Button

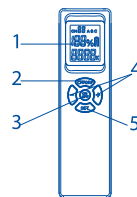

Mounting and Adjusting the Nuada S3II

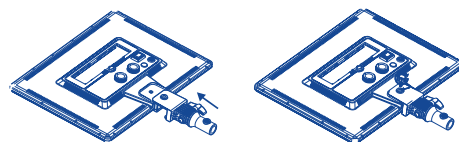

1. Use the Mounting Bracket to mount the Nuada S3II to a Light Stand or other mount. The Nuada S3II can be mounted horizontally or vertically via adjusting the position of the mounting bracket using the swivel lock screw at vertical or horizontal position.
2. Ensure the Mounting Bracket Locking Nut is securely fastened.
3. Nuada S3II mounting bracket is detachable design.
4. Loosen and tighten the Locking Nuts on the Mounting Bracket to adjust the Nuada S3II angle.

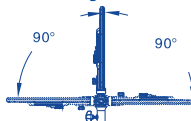

To use NP-F style Batteries.

1. Align the battery with the Battery Port
2. Push the battery until locked into position.
3. Move the Power / Battery / AC Modes Switch to the Battery position.

Please Note:

The Nuada S3II will operate with 2 pcs NP-F style batteries being used only.

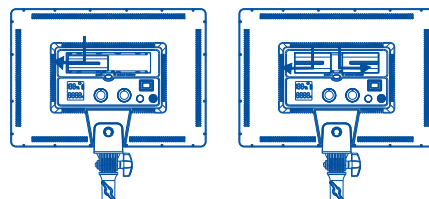

Removing Batteries

Push the battery release button and remove battery from the battery chamber.

Using AC Power

1. Connect the AC Adapter to the AC Adapter Port on the Nuada S3II.
2. Plug the other end of the AC Adapter into mains power.
3. Move the Power / Battery / AC Modes Switch to the AC position.

Power OFF Nuada S3II

Move the Power / Battery / AC Modes Switch to the Center position.

The LCD Display On the Nuada S3II LCD Display

- Brightness displayed from 01-100%.
- Color Temperature is displayed from 2500K-8500K.
- Channel (CH) from 01-40
- Group A/B/C
- The estimated Nuada S3II remaining battery power is indicated by the battery icon.

On the Remote control ECO3 LCD Display

- Brightness displayed from 01-100%.
- Color Temperature is displayed from 2500K-8500K.
- Channel (CH) from 01-40
- Group A/B/C
- The estimated Remote control remaining battery power is indicated by the battery icon.

Adjusting Brightness and Color Temperature on Nuada S3II

1. Turn the Brightness Adjustment Dial to adjust the Nuada S3II output from 1 – 100%.
2. Turn the Color Temperature Adjustment Dial to adjust the Nuada S3II color temperature from 2500K-8500K.

Setting the Group on the Nuada S3II

1. Press the Channel Button (CH/Grp) on Nuada S3II.
2. Use the Brightness Adjustment Dial to set the group between A/B/C.
3. Press the Channel Button (CH/Grp) on Nuada S3II to confirm and exit.

Setting the Wireless Channel on the Nuada S3II

1. Press the Channel Button (CH/Grp) on Nuada S3II.
2. Use the Color Temperature Adjustment Dial to set the Channel from 01-40.
3. Press the Channel Button (CH/Grp) on Nuada S3II to confirm and exit.

Please note:

The Channel and Group on the Remote and Nuada S3II needs to be the same for the remote to control the Nuada S3II.

Using the Remote Control ECO3

The Phottix Nuada S3II comes with wireless remote control. Using this remote, Nuada S3II can be controlled from up to 50m away.

Install Batteries on Remote Control ECO3

1. Slide out back side cover.
2. Insert 2pcs AAA batteries.

Power ON/OFF the Remote Control ECO3

Hold 1sec ON/OFF button on Remote Control to power ON/OFF the Remote Control.

Adjusting Brightness on Remote Control ECO3

Press the + / - buttons to direct adjust output from 01–100%.

Adjusting Color Temperature on Remote Control ECO3

1. Press the Set button
2. Press the + / - buttons to adjust color temperature from 2500K-8500K.
3. Press the ON/OFF button to confirm and exit.

Remote ON/OFF Nuada S3II on Remote Control ECO3

1. Press ON/OFF button on Remote Control to remote ON/OFF the Nuada S3II.
2. LCD will display OFF on both Nuada S3II and remote control when remote Nuada S3II to OFF.

Setting the Group on the Remote Control ECO3

1. Press the CH/Grp Button to enter group setting.
2. Using the + / - buttons to select the group between A/B/C
3. Press the ON/OFF button to confirm and exit.

Setting the Wireless Channel on the Remote Control ECO3

1. Press the CH/Grp Button twice to enter channel setting.
2. Set the Channel from 01-40 using the + / - buttons
3. Press the ON/OFF button to confirm and exit.

Technical Specs

Nuada S3II

Color temperature:	2500K - 8500K
Brightness range:	01% - 100%
Max. brightness / illuminance:	1000Lux @ 1m
Max.Power:	40W @ full power
Color rendering index:	96+ / TLCI 98+
AC/DC adaptor operation voltage:	100-240VAC
Battery operation:	NP-F550 / NP-F750 or NP-F960 battery x2
LED numbers:	144 PCS Cool color 144 PCS Warm color
Dimension:	376mm x 266mm x 25mm
Weight:	1170g (not include battery)

Remote Control ECO3

Remote Control ECO3:	40 channels 2.4G wireless remote control
Remote Control Range:	<50m
Battery operation:	AAA x 2

What's included

- Nuada S3II LED Panel
- Remote control ECO3
- AC Adapter
- Mounting bracket (Installed on unit at Twin Kit version)
- UK plug • US plug • EU plug • SAA plug



安全須知

- 避免用本產品於近距離對人眼直接照射以避免短暫性影響視力。建議近距離使用時加上柔光罩。
- 請勿將本產品存放在酒精或易燃物品附近，以免發生危險。
- 請勿將本產品放置於液體附近，本產品沒有防水，防濺及防塵功能。
- 不要使用稀釋劑，酒精等有機溶劑來清潔產品表面，以免損壞外殼。
- 請勿將本產品存放於攝氏40度以上的地方，避免對內部元件造成損壞。
- 在戶外使用本產品時，請勿長時間在被陽光直射的環境下使用本產品，以免因過熱而造成損壞。

產品功能

Phottix Nuada S3II LED補光燈功率強大，優良光質，適用於攝影及攝錄。備有電池或電源適配器供電模式，LCD顯示，遙控功能，功率及色溫調校。

部件

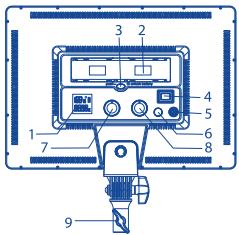

- | | | |
|------------|-----------------------|-----------|
| 1. LCD 顯示屏 | 4. 電源開關選擇 | 7. 亮度調整轉輪 |
| 2. 電池倉 | 5. DC插座 | 8. 色溫調整轉輪 |
| 3. 電池固定鎖 | 6. 頻道 / 組別按鍵 (CH/Grp) | 9. 支架固定旋鈕 |

無線遙控 ECO3

1. LCD顯示屏
2. 頻道 /組別按鍵 (CH/Grp)
3. ON/OFF按鍵
4. +/- 調整鍵
5. 設定鍵 (SET)

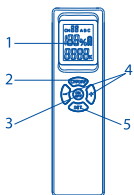

產品安裝及使用

產品安裝

1. 產品可以安裝於市面上所有的1/4螺絲的支架、雲臺等，也可以通過標配的支架將產品安裝於介面直徑 <16mm 的固定杆上。
2. 將產品的固定支架上的支架固定旋鈕逆時針擰出，將固定支架的介面連接到三腳架上，然後將支架固定旋鈕擰緊。
3. 本產品的支架是可裝拆設計如圖。

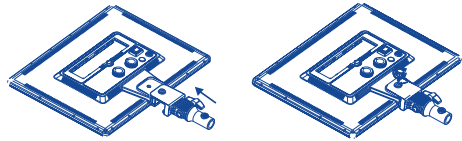

4. 本產品可以通過標配的支架進行前後各 90°的旋轉。將產品上的角度調節旋鈕逆時針擰鬆，然後可以將產品前 90°，後 90°進行調節。產品調節到合適角度之後，順時針擰緊角度調節旋鈕即可。

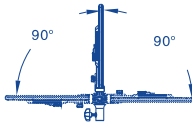

使用NP電池供電

1. 將兩顆索尼NP-F系列的電池卡入到電池倉內。
2. 將電池推進電池倉。
3. 將電源開關撥動到電池端，即可使用電池供電及開啟LED。

註：本產品需安裝兩顆NP-F電池才可以使用。

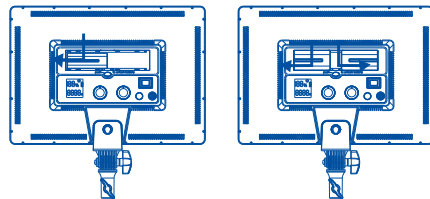

移除電池

按下電池固定鎖並將電池推出

使用外接電源

1. 將外置電源轉接器插入電源插孔。
2. 將電源轉接器另一端連接電源插頭。
3. 將電源開關撥動到AC端，即可使用適配器供電及開啟LED。

開機

將電源開關撥動到中間開關機

LCD顯示屏

Nuada S3II顯示屏顯示

- 亮度顯示由01-100%
- 色溫顯示由2500K-8500K.
- 頻道CH01-40
- 組別A/B/C
- Nuada S3II電池電量估計資訊.

遙控器顯示屏顯示

- 亮度顯示由 01-100%
- 色溫顯示由 2500K-8500K
- 頻道 CH01-40
- 組別 A/B/C
- 遙控器 ECO3 電池電量估計資訊

調整亮度及色溫

1. 旋轉亮度調節旋鈕，調節亮度由 01–100%
2. 旋轉色溫調節旋鈕，調節色溫由 2500K-8500K

在Nuada S3II上設置組別

1. 在Nuada S3II按下 頻道 /組別按鍵 (CH/Grp)
2. 轉動亮度調節旋鈕選擇組別A/B/C
3. 在Nuada S3II按下 頻道 /組別按鍵 (CH/Grp) 確認和退出

在Nuada S3II上設置頻道

1. 在Nuada S3II按下 頻道 /組別按鍵 (CH/Grp)
2. 轉動色溫調整轉輪選擇組別頻道CH 01-40
3. 在Nuada S3II按下 頻道 /組別按鍵 (CH/Grp) 確認和退出

註：Nuada S3II主機跟遙控器 ECO3 的頻道和組別必須一樣才可遙控

使用遙控器 ECO3

本產品附有遙控器 ECO3，可在50米以內遙控Nuada S3II

安裝遙控器 ECO3 電池

1. 拉出遙控器背部後蓋
2. 安裝兩個AAA電池

開關遙控器 ECO3 電源

長按遙控器上 ON/OFF 按鍵1秒開啟或關閉遙控器電源

使用遙控器 ECO3 調節亮度

使用遙控器上的 +/-調整鍵可直接遙控Nuada S3II亮度01–100%

使用遙控器 ECO3 調節色溫

1. 按下遙控器的 設定鍵 (SET)
2. 使用 +/-調整鍵直接可遙控Nuada S3II色溫3200K-5600K
3. 按下ON/OFF 按鍵 確認及退出

使用遙控器 ECO3 開關Nuada S3II主機

1. 使用ON/OFF 按鍵可直接遙控Nuada S3II主機開關
2. Nuada S3II主機以及遙控器上的LCD 顯示屏會顯示OFF狀態

在遙控器 ECO3 上設置組別

1. 在遙控器按下 頻道 / 組別按鍵 (CH/Grp)
2. 使用遙控器上的 +/- 調整鍵 選擇設置組別 A/B/C
3. 按下ON/OFF 按鍵 確認及退出.

在遙控器 ECO3 上設置頻道

1. 在遙控器按下 頻道 / 組別按鍵 (CH/Grp) 兩次
2. 使用遙控器上的 +/- 調整鍵 選擇設置頻道 01-40
3. 按下ON/OFF 按鍵 確認及退出

技術規格

Nuada R3II主機

色溫範圍	2500K - 8500K
調光範圍	01% - 100%
最大照度	1000Lux @ 1m
最大功率	40W
顯色指數 (CRI)	96+ / TLCI 98+
外置電源轉接器電源輸入	100-240VAC
電池種類	NP-F550 / NP-F750 / NP-F960 x 2
LED 數量	144顆冷色 144顆暖色
產品尺寸	376mm x 266mm x 25mm
產品淨重	1170g

遙控器 ECO3

頻道 /遙控	40頻道 2.4G 無線遙控
遙控距離	<50m
電池	AAA x 2

附件

- Nuada S3II 補光燈本體 • 遙控器 ECO3 • 電源適配器
- 插頭(英規) • 插頭(美規) • 插頭(歐規) • 插頭(澳規)
- 固定支架 (雙燈套裝已安裝本體上)

Phottix® 保 修 卡 Warranty Card

Phottix 保修卡

Phottix 將會按當地法規提供保修 / 更換服務。
詳情請查閱 Phottix 網站 phottix.com/warranty

請小心保存此卡，不要遺失

Phottix Warranty Card

Phottix offers warranty service and/or replacement that comply with local regulations.
For full information see: phottix.com/warranty

Keep this card – do not lose.